

Barber Secure Door Lock Schedule	
Door Ref	Description
GD.01	Access Token Reader & Maglock interlinked to GD.02; comprising full height lock protection plate and porthole (porthole cover is required)
GD.02	Access Token Reader & Maglock interlinked to GD.01; comprising full height lock protection plate and porthole
GD.03	Access Token Reader Strike Plate; comprising full height lock protection plate and porthole (porthole cover is required)
GD.04	Access Token Reader Strike Plate; comprising full height lock protection plate and porthole (porthole cover is required)

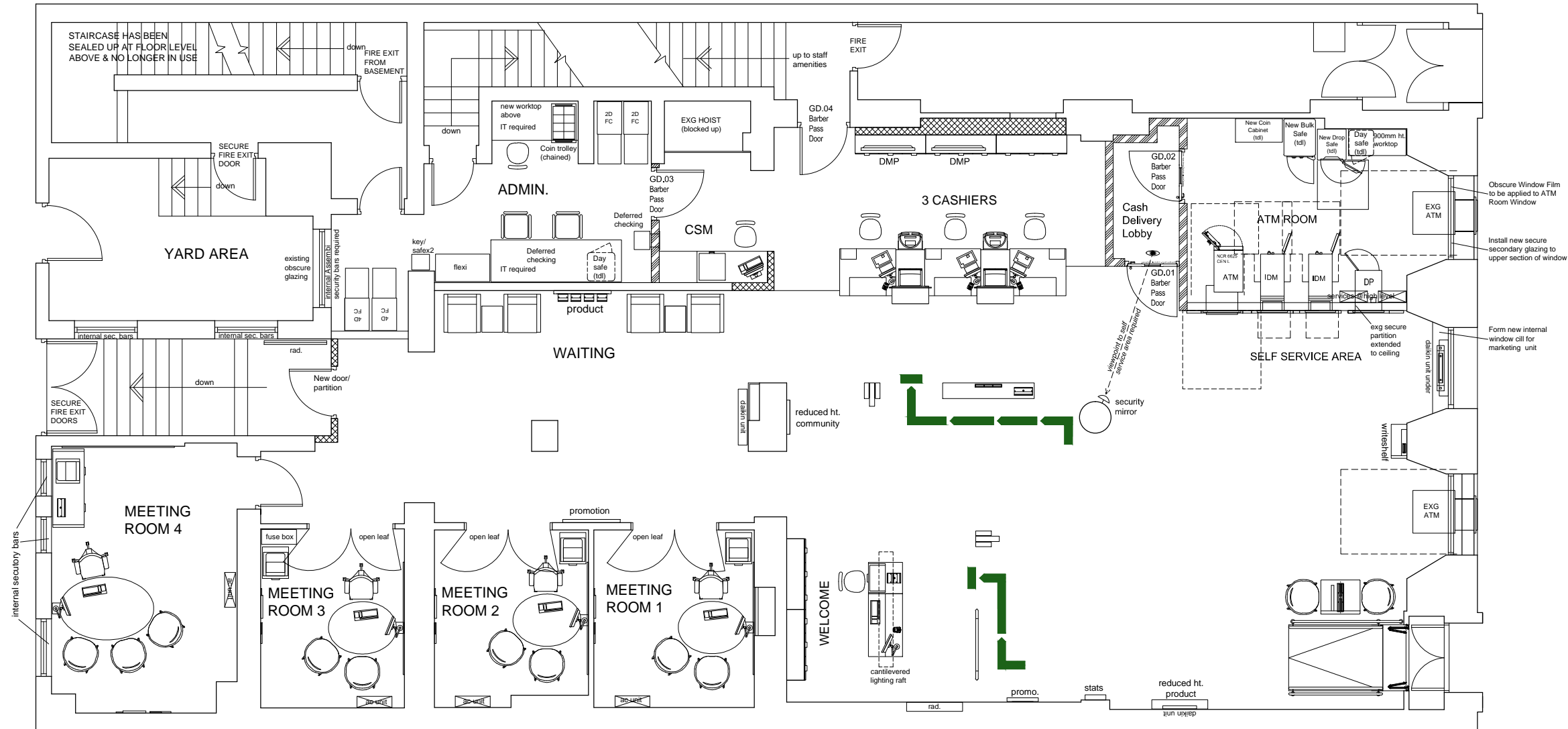
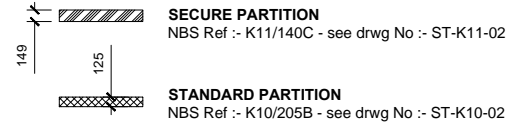
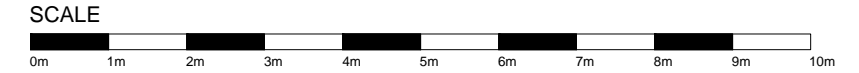

GROUND FLOOR PLAN

REV	DATE	REVISION	INITIALS
B	03.02.15	Amended & updated	GAR
A	16.01.14	Plan amended to SCF1-Rev A Issue	PC
-	15.01.14	First Issue (for SCF1)	PC

LLOYDS BANKING GROUP

ALL DIMENSIONS TO BE VERIFIED PRIOR TO COMMENCING WORK. DRAWING TO BE READ IN CONJUNCTION WITH PROJECT SPECIFICATIONS.

THIS DRAWING IS THE PROPERTY OF LLOYDS BANKING GROUP AND COPYRIGHT IS RESERVED BY THEM. THE DRAWING IS ISSUED ON CONDITION THAT IT IS NOT COPIED OR DISCLOSED BY OR TO ANY UNAUTHORISED PERSONS WITHOUT PRIOR CONSENT IN WRITING TO LLOYDS BANKING GROUP - GROUP PROPERTY. ALL MODIFIED DRAWINGS SHOULD BE RETURNED TO LLOYDS BANKING GROUP.

GROUP PROPERTY

BRISTOL - PO Box 112, Canons House, Canons Way, BRISTOL, BS99 7LB
EDINBURGH - Signal South, 12 Bankhead Crossway South, EDINBURGH, EH11 4EN
HALIFAX - Trinity Road, HALIFAX, West Yorkshire, HX1 2RG

PROJECT ADDRESS	Lloyds Bank South Shields, King Street 101 King Street SOUTH SHIELDS NE33 1DT	SCALE	A1 - 1:50 A3 - 1:100
DRAWING DESCRIPTION	Ground Floor Proposed Plan	DATE	13.01.15
DRAWING NUMBER	50689600-AR01-00-0301	DRAWN BY	PC
		REVISION	B